

## RS100# (11/4" PICH) DIMENSIONS

Bánh Răng Xích (gù)

Chất Liệu S35C

B Type Sprocket

Material S35C

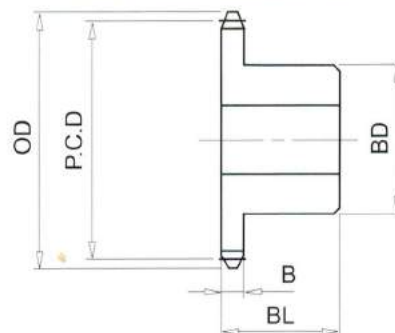

| No. of Teeth | Outside Diam.<br><b>OD</b> | Pitch Diam.<br><b>P.C.D</b> | Bottom or<br>Capliper Diam. | <b>BD</b> | <b>BL</b> | <b>B</b> |
|--------------|----------------------------|-----------------------------|-----------------------------|-----------|-----------|----------|
| 56           | 584                        | 566.25                      | 547.20                      | 147       | 80        | 17.6     |
| 57           | 595                        | 576.35                      | 557.08                      | 147       | 80        | 17.6     |
| 58           | 605                        | 586.45                      | 567.40                      | 147       | 80        | 17.6     |
| 59           | 615                        | 596.56                      | 577.29                      | 147       | 80        | 17.6     |
| 60           | 625                        | 606.66                      | 587.61                      | 147       | 80        | 17.6     |
| 61           | 635                        | 616.76                      | 597.50                      | 147       | 80        | 17.6     |
| 62           | 645                        | 626.86                      | 607.81                      | 147       | 80        | 17.6     |
| 63           | 655                        | 636.96                      | 617.72                      | 147       | 80        | 17.6     |
| 64           | 665                        | 647.07                      | 628.02                      | 147       | 80        | 17.6     |
| 65           | 675                        | 657.17                      | 637.93                      | 147       | 80        | 17.6     |
| 66           | 686                        | 667.27                      | 648.22                      | 147       | 80        | 17.6     |
| 67           | 696                        | 677.37                      | 658.14                      | 147       | 80        | 17.6     |
| 68           | 706                        | 687.48                      | 668.43                      | 147       | 80        | 17.6     |
| 69           | 716                        | 697.58                      | 678.35                      | 147       | 80        | 17.6     |
| 70           | 726                        | 707.68                      | 688.63                      | 147       | 100       | 17.6     |
| 71           | 736                        | 717.78                      | 698.56                      | 147       | 100       | 17.6     |
| 72           | 746                        | 727.89                      | 708.84                      | 147       | 100       | 17.6     |
| 73           | 756                        | 737.99                      | 718.77                      | 147       | 100       | 17.6     |
| 74           | 766                        | 748.09                      | 729.04                      | 147       | 100       | 17.6     |
| 75           | 777                        | 758.20                      | 738.98                      | 147       | 100       | 17.6     |
| 76           | 787                        | 768.30                      | 749.25                      |           |           |          |
| 77           | 797                        | 778.40                      | 759.19                      |           |           |          |
| 78           | 807                        | 788.51                      | 769.46                      |           |           |          |
| 79           | 817                        | 798.61                      | 779.40                      |           |           |          |
| 80           | 827                        | 808.71                      | 789.66                      |           |           |          |